

H: 290 cm.
B: 295 cm.

PORT

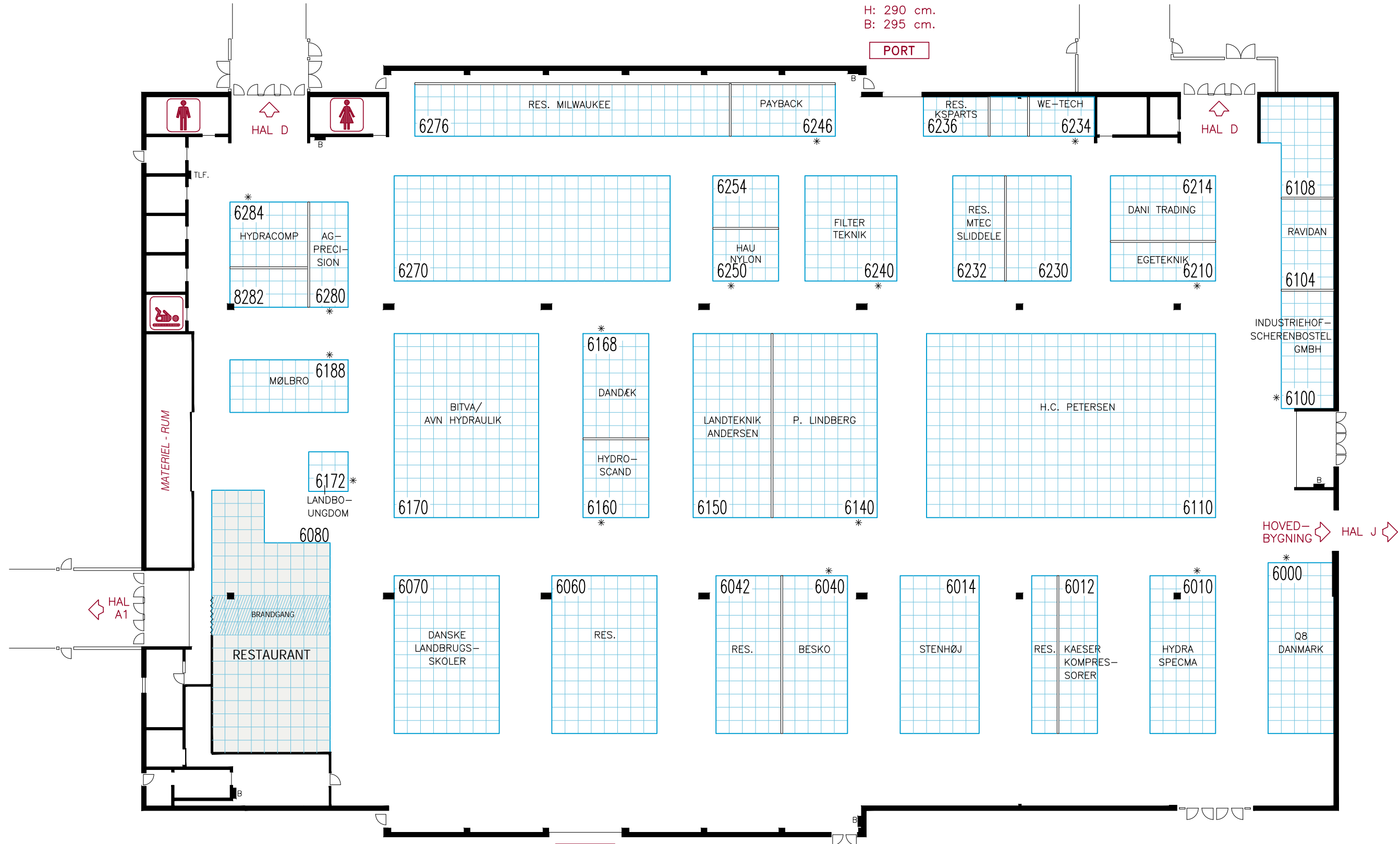

PORT

H: 445 cm.
B: 480 cm.

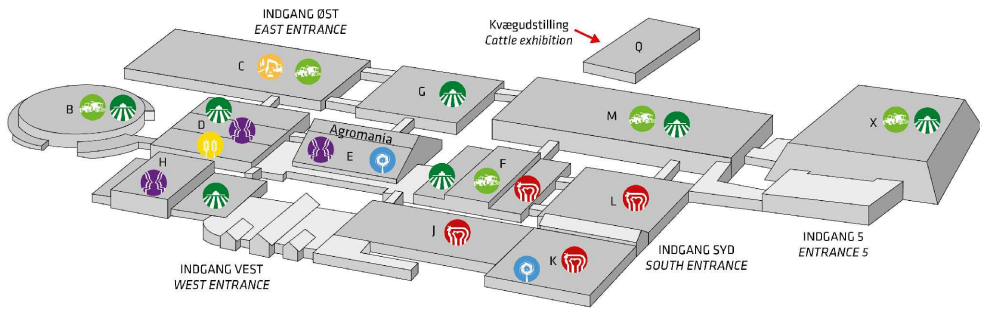

agromek 

19.-22. januar 2021

-  traktorer og høstmaskiner tractors and combine harvesters
-  kornhåndtering crop management
-  energi energy
-  viden og service knowledge and service
-  markredskaber agricultural machinery
-  staldmekanisering livestock machinery
-  entreprenør, vej & park construction, roads and parks

MCH  **HAL H**

Målforhold : 1:300
Revideret : 24.09.20
Tegn. af : PON